

Drain: MASTHEAD DRAIN Drain #: 203
 Improvement/Arm: MASTHEAD-SECTION 14
 Operator: JDH Date: 1-28-04
 Drain Classification: Urban/Rural Year Installed: 1987

GIS Drain Input Checklist

- Pull Source Documents for Scanning JRH 1-28
- Digitize & Attribute Tile Drains N/A
- Digitize & Attribute Storm Drains JRH 1-29
- Digitize & Attribute SSD JRH 1-29
- Digitize & Attribute Open Ditch N/A
- Stamp Plans JRH 1-29
- Sum drain lengths & Validate JRH 1-29
- Enter Improvements into Posse JRH 1-29
- Enter Drain Age into Posse July 3-2
- Sum drain length for Watershed in Posse July 3-2
- Check Database entries for errors JRH 1-29

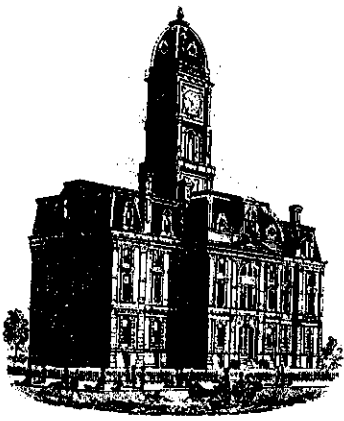

SURVEYOR'S OFFICE

Hamilton County

Kenton C. Ward, Surveyor

773-6110 Ext. 19-
776-9626

Noblesville, Ind. 46060 August 28, 1987

TO: Hamilton County Drainage Board

RE: Masthead Drain-Section 14

FILED
NOV 9 1987

Attached is a petition, non-enforcement request, plans calculations, and assessment roll for the Masthead Drain, Section 14

I have reviewed the submittals and petition and have found each in proper form.

HAMILTON COUNTY DRAINAGE BOARD
SECRETARY

I have made a personal inspection of the land described in the petition. Upon doing so, I believe that the drain is practicable; will improve the public health; benefit a public highway and be of public utility; and that the cost, damages and expenses of the proposed drain will probably be less than the benefits accruing to the owners of land likely to be benefitted. The drain will consist of the following:

6" SSD	1710 ft	21" RCP	420 ft
12" RCP	578 ft	24" RCP	237 ft
15" RCP	515 ft	30" RCP	199 ft
18" RCP	35 ft	36" RCP	502 ft

The total length of the drain will be 4196 feet.

I have reviewed the plans and believe the drain will benefit each lot equally. Therefore, I recommend each lot be assessed equally. I recommend a maintenance assessment of \$20.00 per lot, \$2.00 per acre for roadways, with a \$6.00 minimum. With this assessment the total annual assessment for the drain/this section will be \$614.10. I further recommend the drain be classified as an Urban Drain.

Block A, which is a common drive is shared by Lots 460 to 463. Therefore, this block will not be assessed because title is divided between those lots and will be considered part of the assessment for those lots.

I recommend a hearing be set for November 9, 1987.

KCW/no

Kenton C. Ward-County Surveyor

STATE OF INDIANA)
)
COUNTY OF HAMILTON)

TO: HAMILTON COUNTY DRAINAGE BOARD
% Hamilton County Surveyor, Courthouse, Noblesville, IN 46060

In the matter of Masthead Subdivision,
Section Fourteen Drain Petition.

Petitioner is the owner of all lots in the land affected by the proposed new regulated drain. The drainage will affect various lots in Masthead Section 14, a subdivision in Hamilton County, Indiana. The general route of such drainage shall be in existing easements and along public roads as shown in the plans on file in the Surveyor's Office.

Petitioner believes that the cost, damages and expenses of the proposed improvement will be less than the benefits which will result to the owners of the land likely to be benefited thereby. Petitioner believes the proposed improvements will:

- (a) improve public health
- (b) benefit a public street
- (c) be of public utility

Petitioner agrees to pay the cost of construction of the drainage system and requests periodic maintenance assessments by the Board thereafter.

The Petitioner also agrees to the following:

1. To provide the Drainage Board a Performance Bond for the portion of the drainage system which will be made a regulated drain. The bond will be in the amount of 100% of the Engineers estimate. The bond will be in effect until construction of 100% of the system is completed and so certified by the Engineer.
2. The Petitioner shall retain an Engineer throughout the construction phase. At completion of the project the Petitioner's Engineer shall certify that the drainage system which is to be maintained as a regulated drain has been constructed as per construction plans.

BEFORE THE HAMILTON COUNTY

DRAINAGE BOARD IN THE

MATTER OF THE Masthead Drain-Sec 14 ~~DRAIN~~

NOTICE

TO WHOM IT MAY CONCERN AND

Notice is hereby given of the Hearing of the Hamilton County Drainage Board on the Masthead Drain-Section 14 Drain, on November 9, 1987, at 9:10 A.M. in the Commissioner's Court, 3rd floor, in the Hamilton County Courthouse Noblesville, Indiana and which the Maintenance Report of the Surveyor and the Schedule of Assessments made by the Drainage Board have been filed and are available for public inspection in the office of the Hamilton County Surveyor.

HAMILTON COUNTY DRAINAGE BOARD

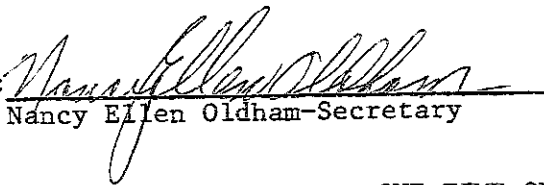
ATTEST: 
Nancy Ellen Oldham-Secretary

ONE TIME ONLY

BEFORE THE HAMILTON
COUNTY DRAINAGE BOARD
IN THE MATTER OF THE

Masthead Drain-Section 14 DRAIN

NOTICE

Notice is hereby given pursuant to Section 405 of the 1965 Indiana Drainage Code that this Board, prior to final adjournment has issued an order adopting the Schedule of Assessments, filed the same and made public announcement thereof at the hearing and ordered publication. If judicial review of the findings and order of the Board is not requested pursuant to Article Eight of this Code within twenty (20) days from the date of this publication, the order shall become conclusive.

HAMILTON COUNTY DRAINAGE BOARD

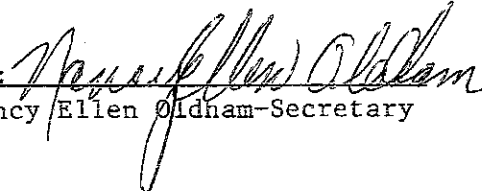
ATTEST: 
Nancy Ellen Oldham-Secretary

One Time Only



June 25, 1987

Irrevocable Letter of Credit No. 2781695685-02048
Expiration Date: June 25, 1988

Hamilton County Commissioners
Hamilton County, Indiana

Gentlemen:

For the account of The Shorewood Corporation, we hereby authorize you to draw on us at sight to the extent of ****U.S. \$75,600.00****.

Each of your drafts must:

1. Be marked "Drawn under PSFS Letter of Credit No. 2781695685-02048 dated June 25, 1987".
2. Be presented, together with this original Letter of Credit at our offices at 1234 Market Street, 9th Floor, Philadelphia, Pennsylvania, 19107, no later than 3:00 p.m. Philadelphia time on June 25, 1988.

3. Be accompanied by the following:

Certification by Hamilton County Commissioners, Hamilton County, Indiana of non-compliance with the specifications required for Storm Sewers in [REDACTED] by The Shorewood Corporation. Such certification may not antedate this Letter of Credit and;

Certification by Hamilton County Commissioners, Hamilton County, Indiana that funds drawn under this Letter of Credit will be used to bring the Storm Sewers into compliance in accordance with the specifications referenced.

4. Not exceed, in the cumulative aggregate \$75,600.00.

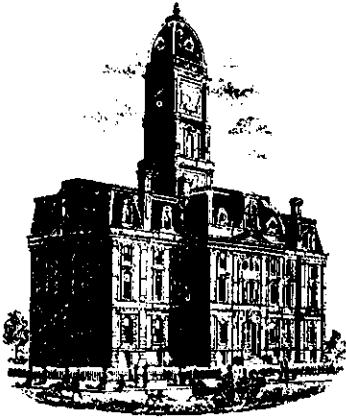

SURVEYOR'S OFFICE
Hamilton County

Kenton C. Ward, Surveyor

Suite 146

776-8495

One Hamilton County Square

Noblesville, Indiana 46060-2230

TO: Hamilton County Drainage Board

RE: Masthead Drain
Masthead Drain Sec. 14

Attached are as-builts, certificate of completion & compliance, and other information for masthead Sec. 14. An inspection of the drainage facilities for this section has been made and the facilities were found to be complete and acceptable.

During construction, changes were made to the drain which will alter the plans submitted with my report for this drain dated August 28, 1987. The changes are as follows: STR 552 was extended to a new manhole approximately 65' feet east of the northwest corner of lot 463. This extension consists of 50' of 12" RCP. The new manhole at the north west corner of lot 463 was then extended along the north line of lot 463 to a metal end section. This extension consists of 100' of 12" RCP. STR 556 to 557 was lengthened from 135' of 30" RCP to 162' feet of 30" RCP. STR 570 to its metal end section was upgraded from a 21" RCP to a 24" RCP of the same length.

The non-enforcement was approved by the Board at its meeting on 12-12-88. The length of the drain due to the changes described above is now 4373 feet.

The bond or letter of credit from Meritor, number 2781695685.02048, dated June 25, 1988, in the amount of \$75,600.00, has been released.

I recommend the Board approve the drains construction as complete and acceptable.

Sincerely,

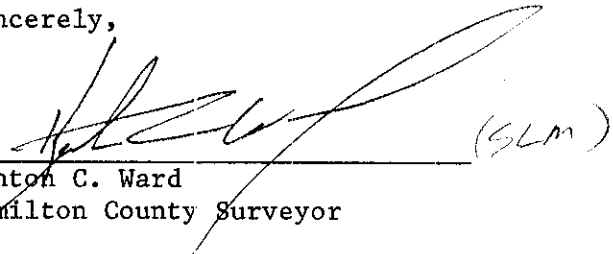
Kenton C. Ward
Hamilton County Surveyor

KCW/nw

CONSTRUCTION PLANS FOR MASTHEAD SECTION FOURTEEN

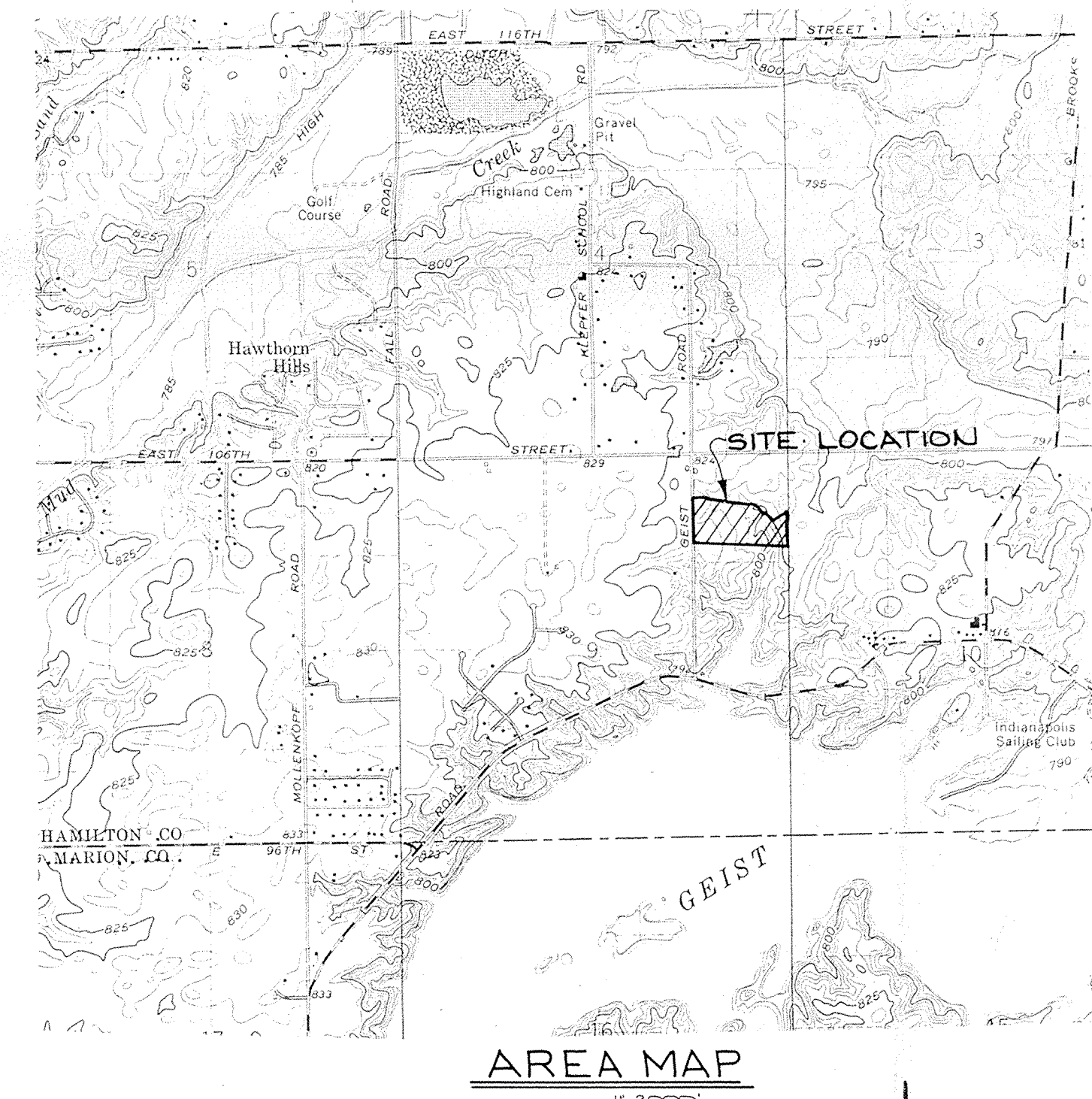
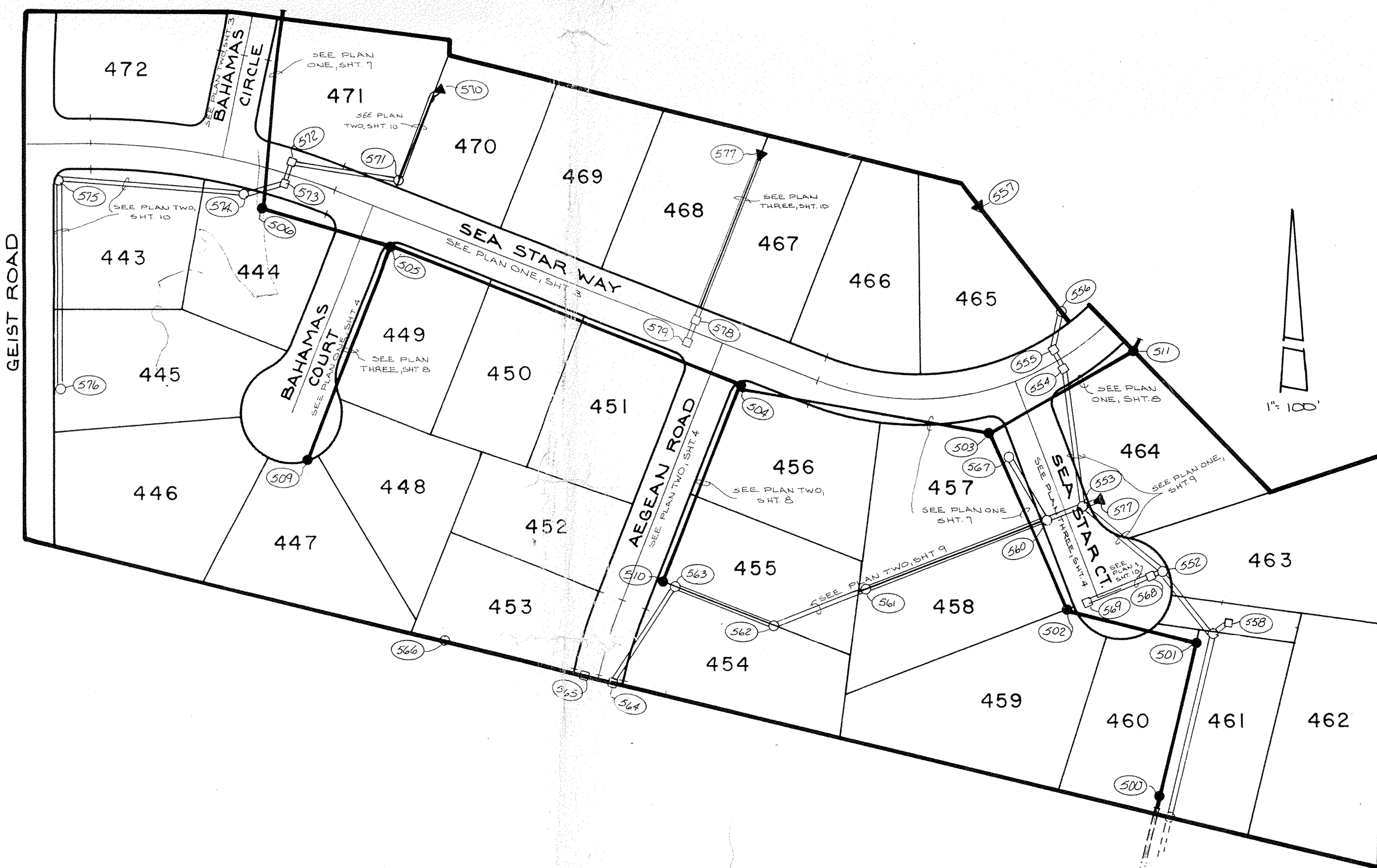

INDEX	
SHT.	DESCRIPTION
1.	COVER SHEET
2.	SITE DEVELOPMENT PLAN
3.	STREET PLAN & PROFILE
4.	STREET PLAN & PROFILE
5.	STREET DETAILS
6.	STREET DETAILS
7.	SANITARY SEWER PLAN & PROFILE
8.	SANITARY SEWER PLAN & PROFILE
9.	STORM SEWER PLAN & PROFILE
10.	STORM SEWER PLAN & PROFILE
11.	STANDARD DETAILS
12.	STANDARD DETAILS & SPECIFICATIONS
13.	EROSION CONTROL PLAN

BENCHMARKS	

REVISIONS	
9-30-84	ADDED STORM BELL DINGS & W/ADDED REVISIONS TO SHT. 11 & 12 ON SHT. 6
	CHANGED CATCH BASIN TYPES ON STR. ON SHT'S 9 & 10
	ADDED NEW DETAIL & SPICES ON SHT'S 11 & 12
2-9-87	ADD 6" RISE RISERS & EROSION CONTROL PLAN CHANGE CLIENT NAME



 This information was gathered for input into the Hamilton County Geographical Information System. This document is considered an official record of the GIS.
 Entry Date: 1-28-04
 Entered by: JPH

FILED
 FEB 26 1987
 HAMILTON COUNTY DRAINAGE BOARD
 SECRETARY

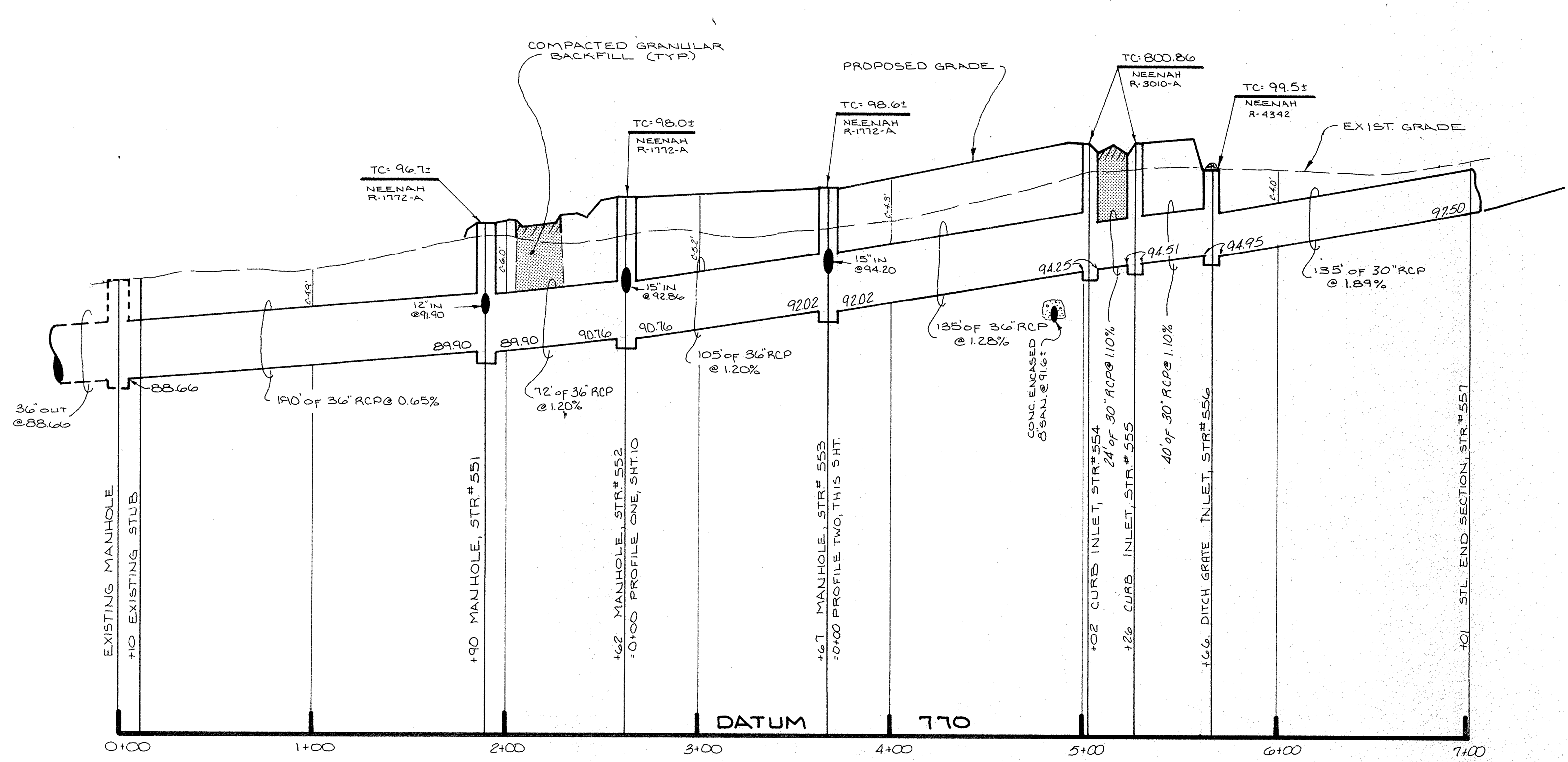
NOTE: CUTS SHOWN ARE APPROXIMATE, TAKEN FROM EXIST. GRADE TO INVERT OF PIPE.

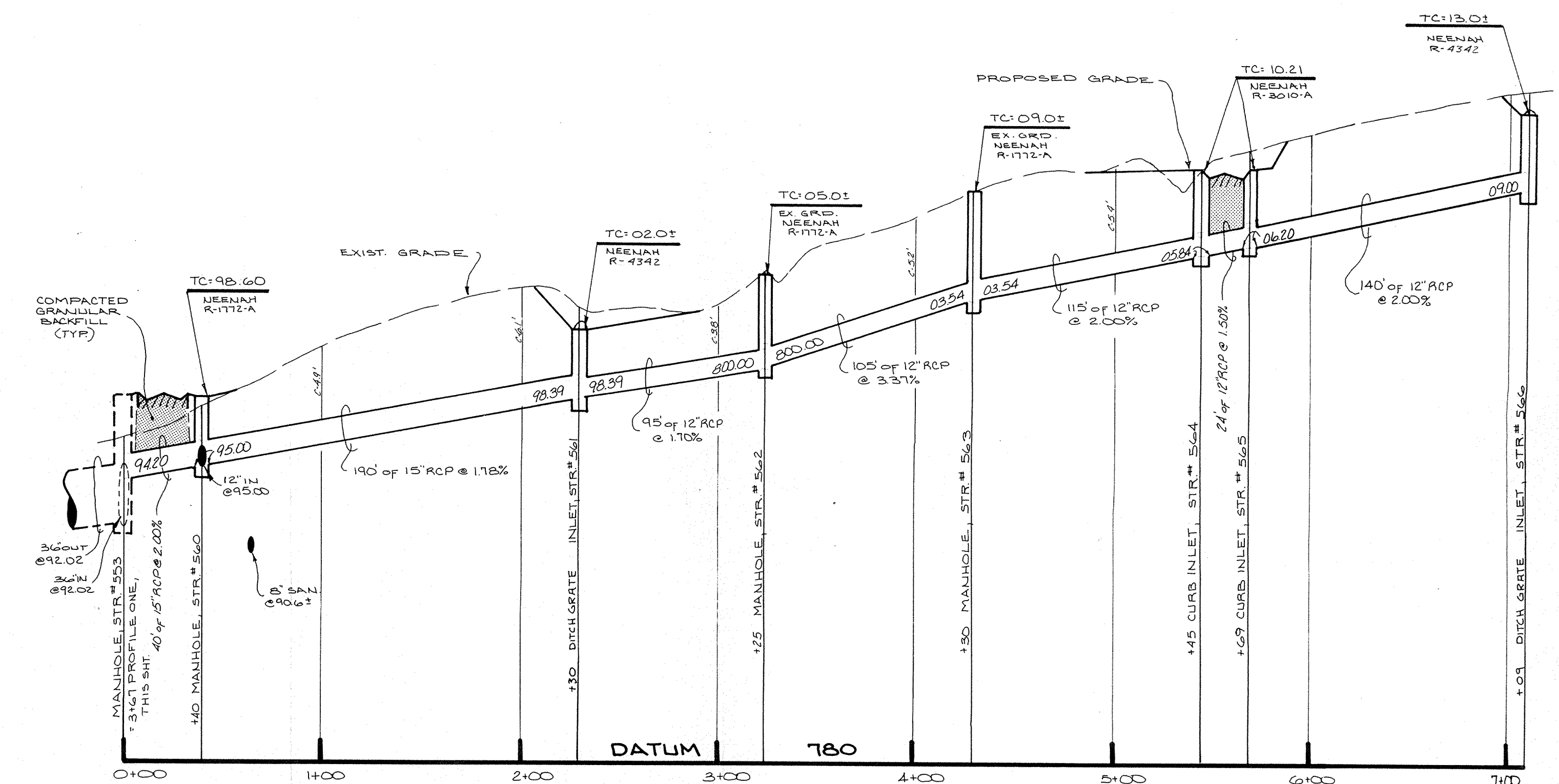

PROFILE ONE



PROFILE TWO

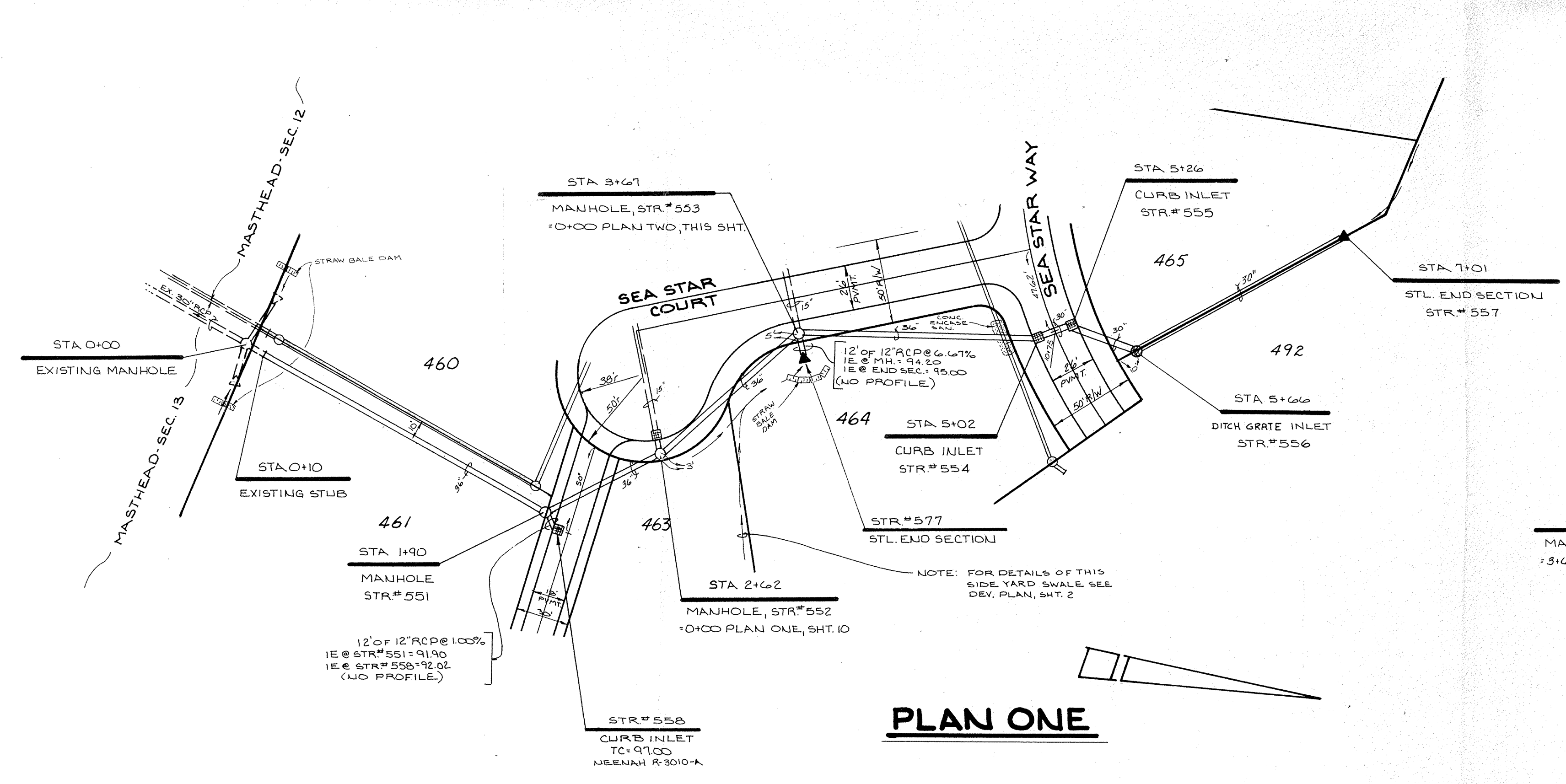

PLAN ONE

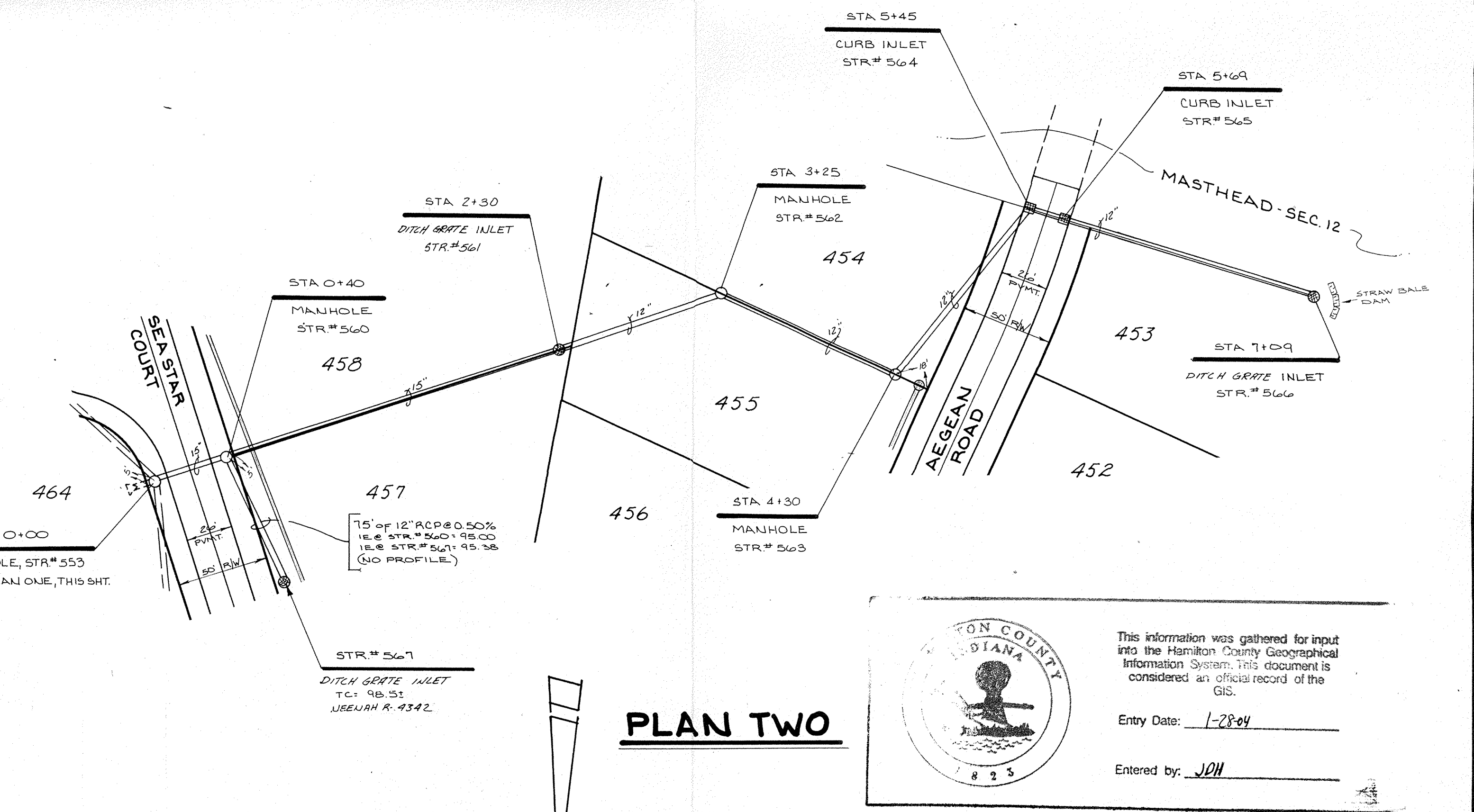

PLAN TWO

This information was gathered for input into the Hamilton County Geographical Information System. This document is considered an official record of the GIS.

Entry Date: 1-28-04

Entered by: JDN

CERTIFIED BY DATE	REVISIONS 5/12/06 CHANGE FROM 36\"/>	PAUL I. CRIFE, INC. 7172 GRAHAM ROAD INDIANAPOLIS, INDIANA 46250 (317) 842-6777	TECH. CHK. DFTNG. CHK.	DRAWN BY <i>JDN</i> DRAWING TITLE STORM SEWER PLAN & PROFILE	SCALE HORIZ. 1\"/>	DATE 1-2-06	CLIENT THE SHOREWOOD CORP.	DWG. TYPE FILE NUMBER JOB NUMBER 83399-00100	SHEET 9 OF 13
--------------------------	-----------------------------------------	-------------------------------------------------------------------------------------------------	-------------------------------	--------------------------------------------------------------------------------------	-----------------------	----------------	-------------------------------	-------------------------------------------------------	----------------------------

NOTE: CUTS SHOWN ARE APPROXIMATE, TAKEN FROM EXIST. GRADE TO INVERT OF PIPE.

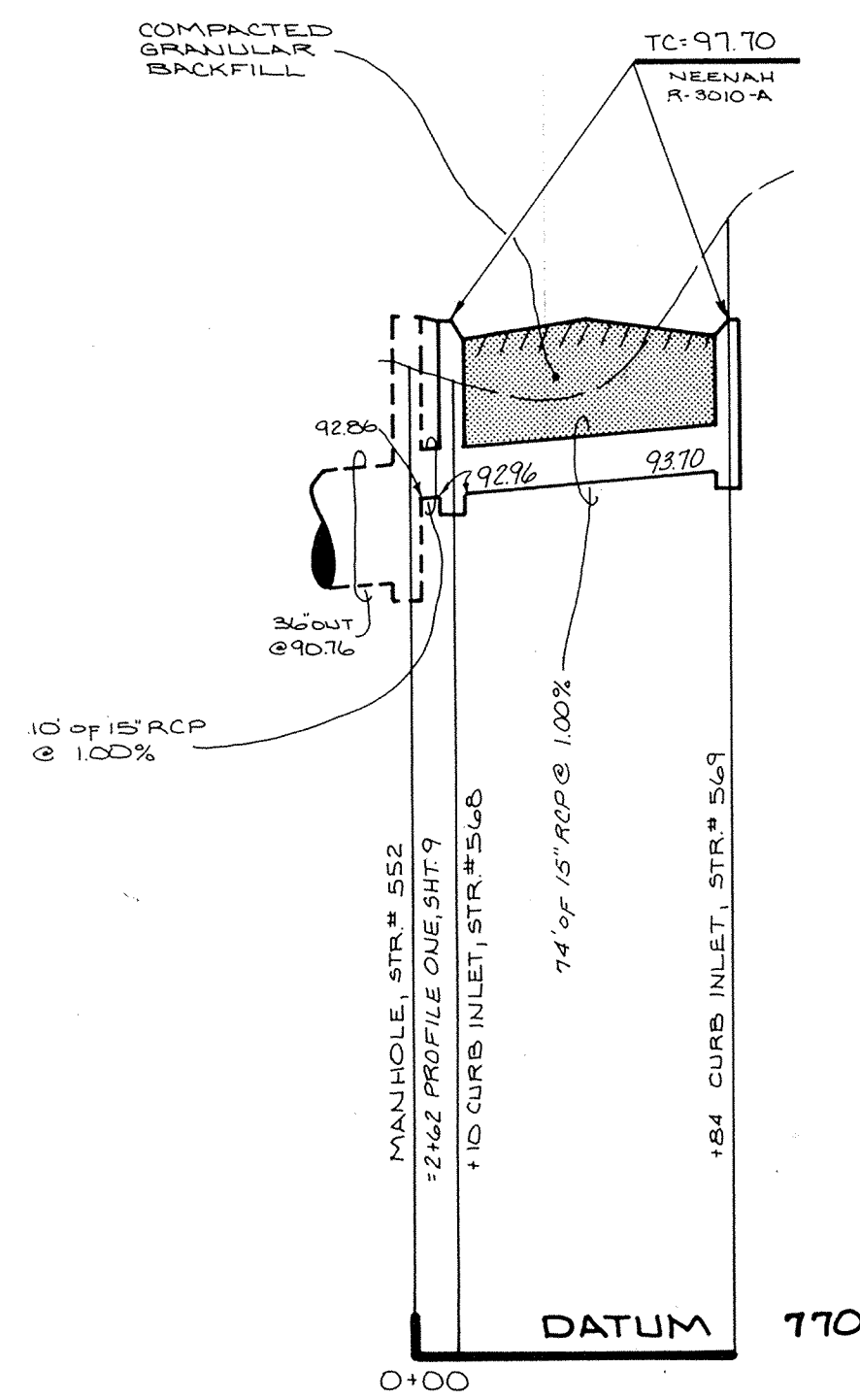

PROFILE ONE

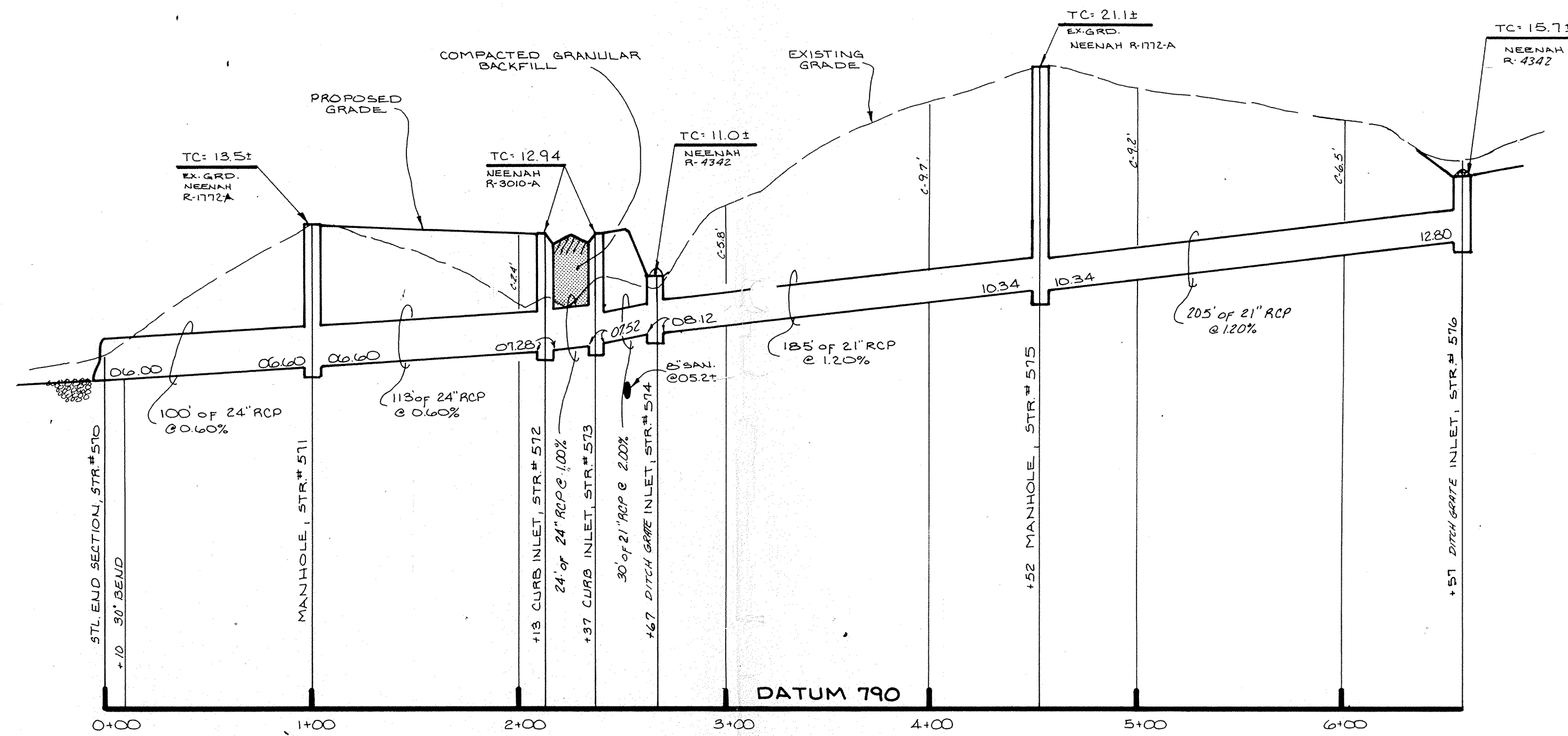

PROFILE TWO

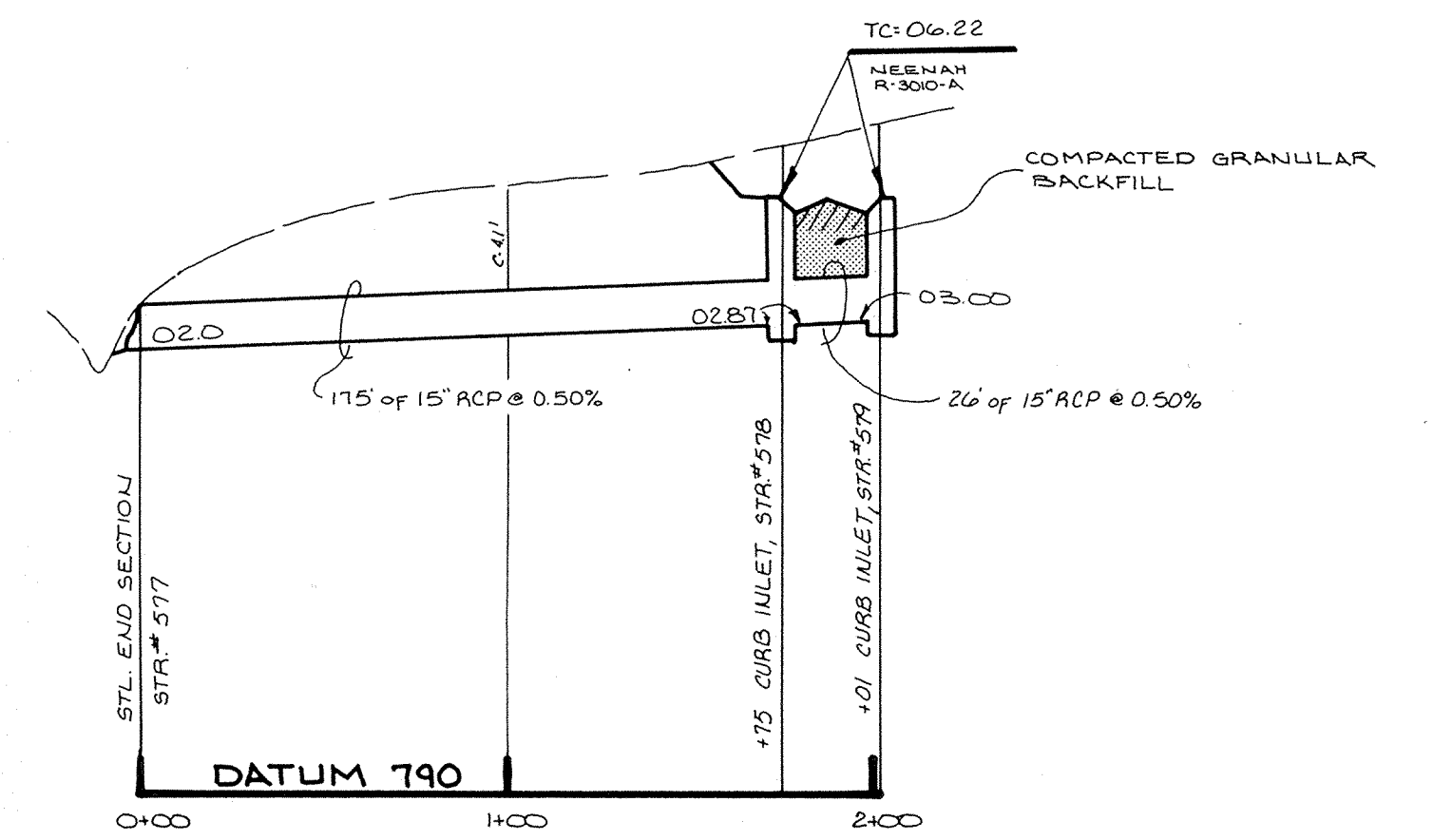

PROFILE THREE

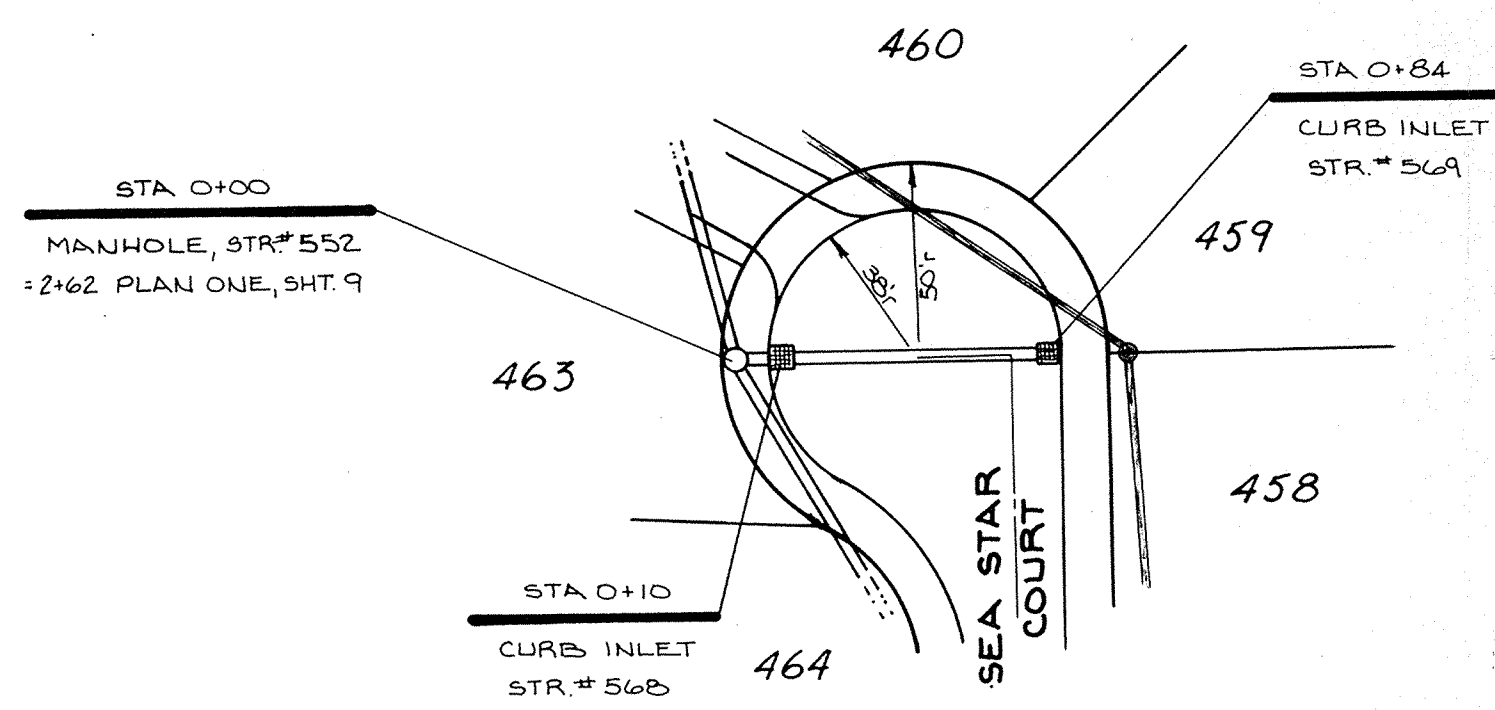

PLAN ONE

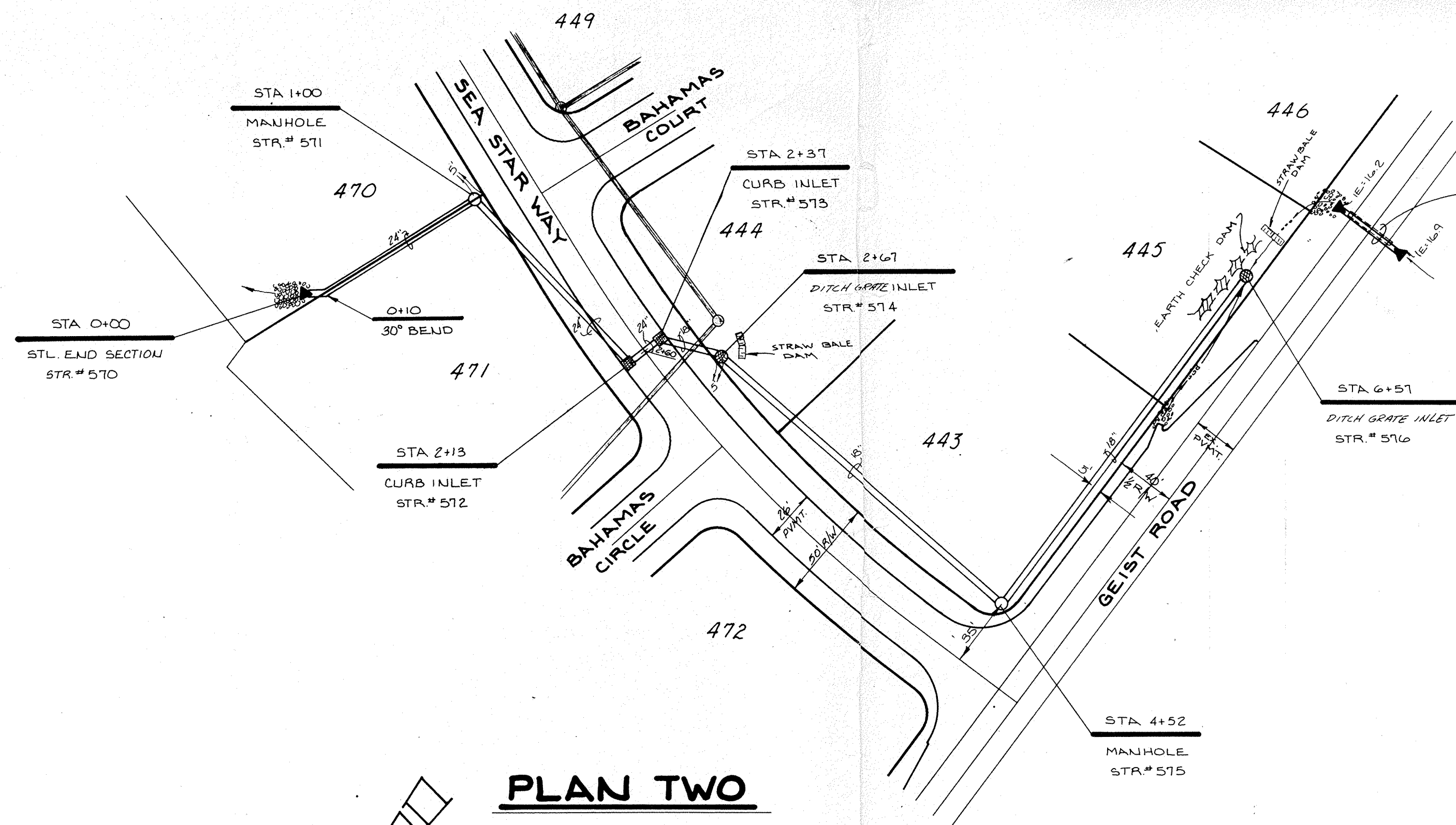

PLAN TWO

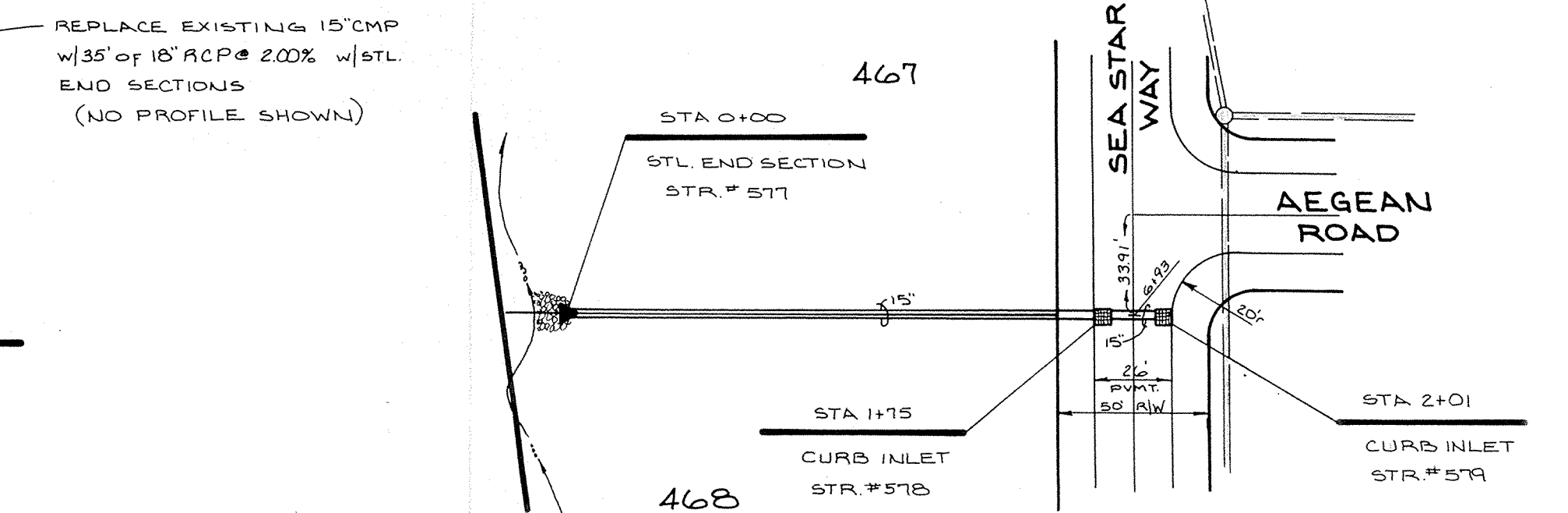

PROFILE THREE

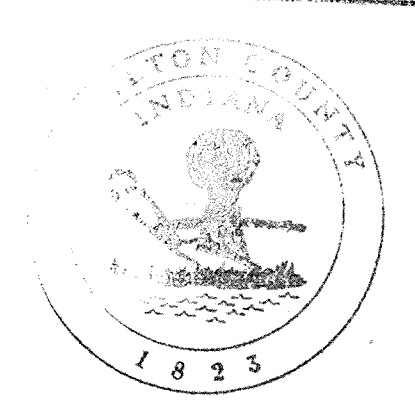
 This information was gathered for input into the Hamilton County Geographical Information System. This document is considered an official record of the GIS.
 Entry Date: 1-29-04
 Entered by: JOH

CERTIFIED BY	REVISIONS	 PAUL I. CRIFE, INC. 7172 GRAHAM ROAD INDIANAPOLIS, INDIANA 46250 317-842-6777	TECH. CHK.	DRAWN BY	SCALE	DATE	CLIENT	MASTHEAD - SEC. 14	
			DFTNG. CHK.	DRAWING TITLE	HORZ. 1"=30'	VERT. 1"=5'	4-2-06	THE SHOREWOOD CORP.	DWG. TYPE
DATE								JOB NUMBER	10
								83399-00100	OF 13

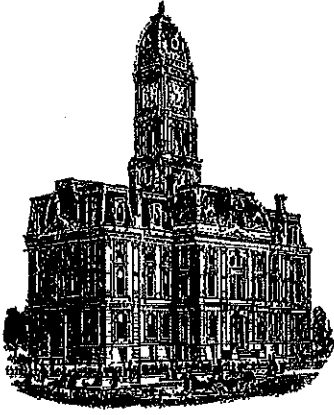

Kenton C. Ward, CEM
Surveyor of Hamilton County
Phone (317) 776-8495
Fax (317) 776-9628

Suite 188
One Hamilton County Square
Noblesville, Indiana 46060-2230

Map Correction-Field Verification

Drain Number: 203

Drain Length: 4373

Drain Name: Masthead Sec. 14

Change + / - : -20

Date: September 30, 2021

New Length: 4353

Verified By: SAB, SLM (WO-2020-0387)

Notes & Sketch: See Attached Map

Work Order investigation revealed that 30" RCP running along East property line of lot 465 was extended to the North East corner of the lot. A manhole was set (Structure 600). Structure 557 as reflected on the as built was not installed. Due to the extension of the 30" RCP, the 6" SSD along the East property line was not installed. It should also be noted that the 6" running Eastward from structure 600 does not tie into the manhole. The 6" SSD is blind tapped into the 30" RCP near the structure. This 6" SSD is the line running across rear yard of lot 492 in Masthead Sec 15.

Suzanne L. Mills
GIS Specialist

STR 557 WAS OMITTED A MH WAS PLACED AT THE NE CORNER OF LOT 465

6" ssd along East Property line was not installed

